

TRAFFIC CRASH REPORT

*DENOTES MANDATORY FIELD FOR SUPPLEMENT REPORT

LOCAL REPORT NUMBER*

19-18750

PHOTOS TAKEN
 SECONDARY CRASH
 OH-2
 OH-1P
 PRIVATE PROPERTY
 OH-3
 OTHER

LOCAL INFORMATION
 REPORTING AGENCY NAME*
 JACKSON TWP POLICE DEPARTME

HIT/SKIP: 1 - SOLVED, 2 - UNSOLVED
 NUMBER OF UNITS: 01
 UNIT IN ERROR: 01 (98 - ANIMAL, 99 - UNKNOWN)

COUNTY*: 76
 LOCALITY*: 3 (1 - CITY, 2 - VILLAGE, 3 - TOWNSHIP)
 LOCATION: CITY, VILLAGE, TOWNSHIP*
 Jackson (Township of)

CRASH DATE / TIME*: 04202019 2351
 CRASH SEVERITY: 5 (1 - FATAL, 2 - SERIOUS INJURY SUSPECTED, 3 - MINOR INJURY SUSPECTED, 4 - INJURY POSSIBLE, 5 - PROPERTY DAMAGE ONLY)

LOCATION ROAD NAME: WHIPPLE
 ROAD TYPE: AV

LATITUDE DECIMAL DEGREES: 40.832400

REFERENCE ROAD NAME (ROAD, MILEPOST, HOUSE #): 2939
 ROAD TYPE:

LONGITUDE DECIMAL DEGREES: -81.424600

REFERENCE POINT: 3 (1 - INTERSECTION, 2 - MILE POST, 3 - HOUSE #)
 DIRECTION FROM REFERENCE: 1 - NORTH, 2 - SOUTH, 3 - EAST, 4 - WEST
 ROUTE TYPE: IR - INTERSTATE ROUTE (TP), US - FEDERAL US ROUTE, SR - STATE ROUTE, CR - NUMBERED COUNTY ROUTE, TR - NUMBERED TOWNSHIP ROUTE
 ROAD TYPE: AL - ALLEY, AV - AVENUE, BL - BOULEVARD, CR - CIRCLE, CT - COURT, DR - DRIVE, HE - HEIGHTS
 HW - HIGHWAY, LA - LANE, MP - MILEPOST, OV - OVAL, PK - PARKWAY, PI - PIKE, PL - PLACE, RD - ROAD, SQ - SQUARE, ST - STREET, TE - TERRACE, TL - TRAIL, WA - WAY

INTERSECTION RELATED:
 WITHIN INTERSECTION OR ON APPROACH
 WITHIN INTERCHANGE AREA
 ROADWAY:
 ROADWAY DIVIDED

LOCATION OF FIRST HARMFUL EVENT: 06 (1 - ON ROADWAY, 2 - ON SHOULDER, 3 - IN MEDIAN, 4 - ON ROADSIDE, 5 - ON GORE, 6 - OUTSIDE TRAFFIC WAY, 7 - ON RAMP, 8 - OFF RAMP, 9 - CROSSOVER, 10 - DRIVEWAY/ALLEY ACCESS, 11 - RAILWAY GRADE CROSSING, 12 - SHARED USE PATHS OR TRAILS, 13 - BIKE LANE, 14 - TOLL BOOTH, 99 - OTHER / UNKNOWN)

MANNER OF CRASH COLLISION/IMPACT: 1 (1 - NOT COLLISION BETWEEN TWO MOTOR VEHICLES IN TRANSPORT, 2 - REAR-END, 3 - HEAD-ON, 4 - REAR-TO-REAR, 5 - BACKING, 6 - ANGLE, 7 - SIDESWIPE, SAME DIRECTION, 8 - SIDESWIPE, OPPOSITE DIRECTION, 9 - OTHER / UNKNOWN)

DIRECTION OF TRAVEL: 1 - NORTH, 2 - SOUTH, 3 - EAST, 4 - WEST
 MEDIAN TYPE: 1 - DIVIDED FLUSH MEDIAN (<4 FEET), 2 - DIVIDED FLUSH MEDIAN (≥4 FEET), 3 - DIVIDED, DEPRESSED MEDIAN, 4 - DIVIDED, RAISED MEDIAN (ANY TYPE), 9 - OTHER/UNKNOWN

WORK ZONE RELATED
 WORKERS PRESENT
 LAW ENFORCEMENT PRESENT
 ACTIVE SCHOOL ZONE

WORK ZONE TYPE: 1 - LANE CLOSURE, 2 - LANE SHIFT/CROSSOVER, 3 - WORK ON SHOULDER OR MEDIAN, 4 - INTERMITTENT OR MOVING WORK, 5 - OTHER

LOCATION OF CRASH IN WORK ZONE: 1 - BEFORE THE 1ST WORK ZONE WARNING SIGN, 2 - ADVANCE WARNING AREA, 3 - TRANSITION AREA, 4 - ACTIVITY AREA, 5 - TERMINATION AREA

CONTOUR: 1 (1 - STRAIGHT LEVEL, 2 - STRAIGHT GRADE, 3 - CURVE LEVEL, 4 - CURVE GRADE, 9 - OTHER/UNKNOWN)

CONDITIONS: 1 (1 - DRY, 2 - WET, 3 - SNOW, 4 - ICE, 5 - SAND, MUD, DIRT, OIL, GRAVEL, 6 - WATER (STANDING, MOVING), 7 - SLUSH, 9 - OTHER/UNKNOWN)

SURFACE: 2 (1 - CONCRETE, 2 - BLACKTOP, BITUMINOUS, ASPHALT, 3 - BRICK/BLOCK, 4 - SLAG, GRAVEL, STONE, 5 - DIRT, 9 - OTHER/UNKNOWN)

LIGHT CONDITION: 3 (1 - DAYLIGHT, 2 - DAWN/DUSK, 3 - DARK - LIGHTED ROADWAY, 4 - DARK - ROADWAY NOT LIGHTED, 5 - DARK - UNKNOWN ROADWAY LIGHTING, 9 - OTHER / UNKNOWN)

WEATHER: 99 (1 - CLEAR, 2 - CLOUDY, 3 - FOG, SMOG, SMOKE, 4 - RAIN, 5 - SLEET, HAIL, 6 - SNOW, 7 - SEVERE CROSSWINDS, 8 - BLOWING SAND, SOIL, DIRT, SNOW, 9 - FREEZING RAIN OR FREEZING DRIZZLE, 99 - OTHER / UNKNOWN)

NARRATIVE
 UNIT 1 BACKED FROM A MARKED PARKING SPACE AND STRUCK THE PUMP GUARD. UNIT 1 HAD DAMAGE TO HIS LEFT REAR SIDE OF HIS VEHICLE. UNIT 1 THEN LEFT THE SCENE WITHOUT PROVIDING ANY INFORMATION TO SHEETZ GAS STATION 2939 WHIPPLE AVE NW. THE INCIDENT WAS REPORTED BY A PASSERBY. OFFICERS REPORTED THE INCIDENT TO SHEETZ AND REQUESTED THE VIDEO. OFFICERS WERE ABLE TO DETERMINE WHO THE AT FAULT VEHICLE WAS. HE WAS ISSUED A CITATION FOR NOT STOPPING AFTER AN ACCIDENT.
 U-379
 KB

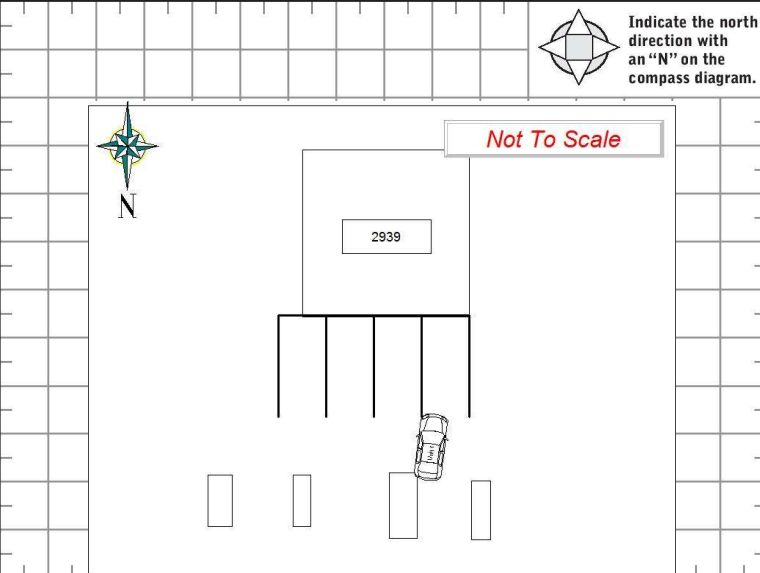

CRASH REPORTED DATE / TIME: 04212019 0006
 DISPATCH DATE / TIME: 04212019 0010
 ARRIVAL DATE / TIME: 04212019 0010
 SCENE CLEARED DATE / TIME: 05062019 0027
 REPORT TAKEN BY: POLICE AGENCY, MOTORIST
 OFFICER'S NAME*: RICE, TIM
 CHECKED BY OFFICER'S NAME*: MCCULLOUGH, TIMOTHY
 OFFICER'S BADGE NUMBER*: 108
 CHECKED BY OFFICER'S BADGE NUMBER*: 31
 TOTAL TIME ROADWAY CLOSED: 0
 OTHER INVESTIGATION TIME: 30
 TOTAL MINUTES: 47
 SUPPLEMENT (CORRECTION OR ADDITION TO AN EXISTING REPORT SENT TO OOPS):

19-18750

OWNER

UNIT # 01 OWNER NAME: LAST, FIRST, MIDDLE SAME AS DRIVER OWNER PHONE: INCLUDE AREA CODE SAME AS DRIVER

OWNER ADDRESS: STREET, CITY, STATE, ZIP SAME AS DRIVER

COMMERCIAL CARRIER: NAME, ADDRESS, CITY, STATE, ZIP COMMERCIAL CARRIER PHONE: INCLUDE AREA CODE

DAMAGE

DAMAGE SCALE

3 1 - NONE 3 - FUNCTIONAL DAMAGE
2 - MINOR DAMAGE 4 - DISABLING DAMAGE
9 - UNKNOWN

VEHICLE

LP STATE OH LICENSE PLATE # HEG6391 VEHICLE IDENTIFICATION # 5XXGT4L32HG155999 VEHICLE YEAR 2017 VEHICLE MAKE KIA

INSURANCE VERIFIED INSURANCE COMPANY GEICO INSURANCE POLICY # 4486744198 COLOR BLK VEHICLE MODEL OPT

COMMERCIAL GOVERNMENT IN EMERGENCY RESPONSE TYPE OF USE

INTERLOCK DEVICE EQUIPPED HIT/SKIP UNIT #OCCUPANTS 01 VEHICLE WEIGHT GVWR/GCWR 1 - ≤10K LBS. 2 - 10,001 - 26K LBS. 3 - >26K LBS. HAZARDOUS MATERIAL MATERIAL RELEASED PLACARD CLASS # PLACARD ID #

01 UNIT TYPE 1 - PASSENGER CAR 7 - MOTORCYCLE 2-WHEELED 12 - GOLF CART 18 - LIMO (LIVERY VEHICLE) 23 - PEDESTRIAN / SKATER
2 - PASSENGER VAN (MINIVAN) 8 - MOTORCYCLE 3-WHEELED 13 - SNOWMOBILE 19 - BUS (16+ PASSENGERS) 24 - WHEELCHAIR (ANY TYPE)
3 - SPORT UTILITY VEHICLE 9 - AUTOCYCLE 14 - SINGLE UNIT TRUCK 20 - OTHER VEHICLE 25 - OTHER NON-MOTORIST
4 - PICK UP 10 - MOPED OR MOTORIZED BICYCLE 15 - SEMI-TRACTOR 21 - HEAVY EQUIPMENT 26 - BICYCLE
5 - CARGO VAN 11 - ALL TERRAIN VEHICLE (ATV / UTV) 16 - FARM EQUIPMENT 22 - ANIMAL WITH RIDER OR ANIMAL-DRAWN VEHICLE 27 - TRAIN
6 - VAN (9-15 SEATS) 17 - MOTORHOME 99 - UNKNOWN OR HIT/SKIP

0 # OF TRAILING UNITS

2 WAS VEHICLE OPERATING IN AUTONOMOUS MODE WHEN CRASH OCCURRED? 0 AUTONOMOUS MODE LEVEL 0 - NO AUTOMATION 3 - CONDITIONAL AUTOMATION 9 - UNKNOWN
1 - DRIVER ASSISTANCE 4 - HIGH AUTOMATION
2 - PARTIAL AUTOMATION 5 - FULL AUTOMATION

01 SPECIAL FUNCTION 1 - NONE 6 - BUS - CHARTER/TOUR 11 - FIRE 16 - FARM 21 - MAIL CARRIER
2 - TAXI 7 - BUS - INTERCITY 12 - MILITARY 17 - MOWING 99 - OTHER / UNKNOWN
3 - ELECTRONIC RIDE SHARING 8 - BUS - SHUTTLE 13 - POLICE 18 - SNOW REMOVAL
4 - SCHOOL TRANSPORT 9 - BUS - OTHER 14 - PUBLIC UTILITY 19 - TOWING
5 - BUS - TRANSIT/COMMUTER 10 - AMBULANCE 15 - CONSTRUCTION EQUIPMENT 20 - SAFETY SERVICE PATROL

01 CARGO BODY TYPE 1 - NO CARGO BODY TYPE / NOT APPLICABLE 3 - VEHICLE TOWING ANOTHER MOTOR VEHICLE 5 - INTERMODAL CONTAINER CHASSIS 8 - POLE 12 - CONCRETE MIXER
2 - BUS 4 - LOGGING 6 - CARGO VAN/ENCLOSED BOX 10 - FLAT BED 14 - GARBAGE/REFUSE
7 - GRAIN/CHIPS/GRAVEL 11 - DUMP 99 - OTHER / UNKNOWN

VEHICLE DEFECTS 1 - TURN SIGNALS 4 - BRAKES 7 - WORN OR SLICK TIRES 9 - MOTOR TROUBLE 99 - OTHER / UNKNOWN
2 - HEAD LAMPS 5 - STEERING 8 - TRAILER EQUIPMENT DEFECTIVE 10 - DISABLED FROM PRIOR ACCIDENT
3 - TAIL LAMPS 6 - TIRE BLOWOUT

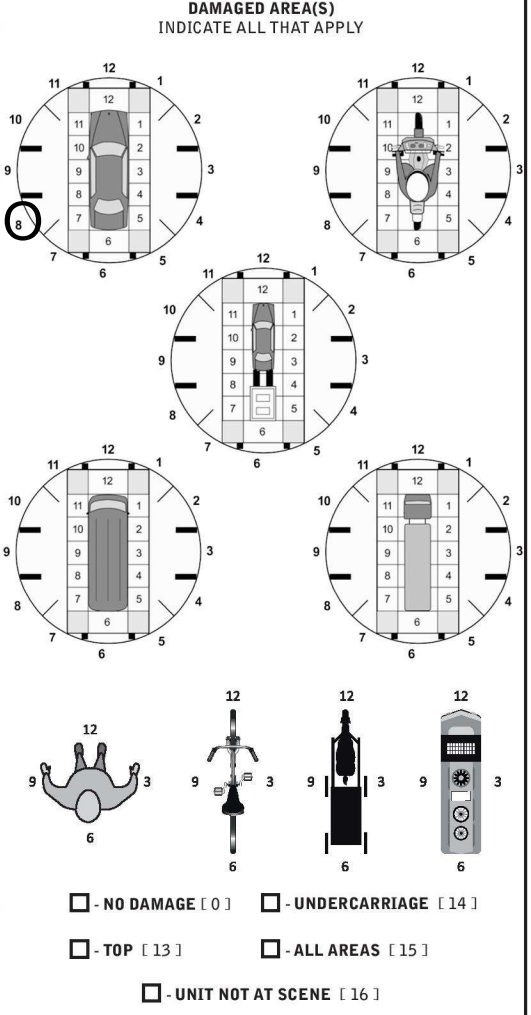

NON-MOTORIST LOCATION AT IMPACT 1 - INTERSECTION - MARKED CROSSWALK 3 - INTERSECTION - OTHER 6 - BICYCLE LANE 9 - MEDIAN/CROSSING ISLAND 12 - FIRST RESPONDER AT INCIDENT SCENE
2 - INTERSECTION - UNMARKED CROSSWALK 4 - MIDBLOCK - MARKED CROSSWALK 7 - SHOULDER / ROADSIDE 10 - DRIVEWAY ACCESS 13 - AUTO TRANSPORTER
5 - TRAVEL LANE - OTHER LOCATION 8 - SIDEWALK 11 - SHARED USE PATHS OR TRAILS 99 - OTHER / UNKNOWN

3 ACTION 1 - NON-CONTACT 2 - NON-COLLISION 3 - STRIKING 4 - STRUCK 5 - BOTH STRIKING & STRUCK 9 - OTHER / UNKNOWN

02 PRE-CRASH ACTIONS 1 - STRAIGHT AHEAD 2 - BACKING 3 - CHANGING LANES 4 - OVERTAKING/PASSING 5 - MAKING RIGHT TURN 6 - MAKING LEFT TURN
7 - MAKING U-TURN 8 - ENTERING TRAFFIC LANE 9 - LEAVING TRAFFIC LANE 10 - PARKED 11 - SLOWING OR STOPPED IN TRAFFIC 12 - DRIVERLESS
13 - NEGOTIATING A CURVE 14 - ENTERING OR CROSSING SPECIFIED LOCATION 15 - WALKING, RUNNING, JOGGING, PLAYING 16 - WORKING 17 - PUSHING VEHICLE
18 - APPROACHING OR LEAVING VEHICLE 19 - STANDING 20 - OTHER NON-MOTORIST 21 - STANDING OUTSIDE DISABLED VEHICLE 99 - OTHER / UNKNOWN

INITIAL POINT OF CONTACT

8 0 - NO DAMAGE 14 - UNDERCARRIAGE
1-12 - REFER TO UNIT DIAGRAM 15 - VEHICLE NOT AT SCENE
13 - TOP 99 - UNKNOWN

12 CONTRIBUTING CIRCUMSTANCES 1 - NONE 7 - LEFT OF CENTER 13 - IMPROPER START FROM A PARKED POSITION 17 - VISION OBSTRUCTION 21 - LYING IN ROADWAY
2 - FAILURE TO YIELD 8 - FOLLOWING TOO CLOSE / ACDA 14 - STOPPED OR PARKED ILLEGALLY 18 - OPERATING DEFECTIVE EQUIPMENT 22 - NOT DISCERNIBLE
3 - RAN RED LIGHT 9 - IMPROPER LANE CHANGE 15 - SWERVING TO AVOID 19 - LOAD SHIFTING/FALLING/SPILLING 23 - OPENING DOOR INTO ROADWAY
4 - RAN STOP SIGN 10 - IMPROPER PASSING 16 - WRONG WAY 20 - IMPROPER CROSSING 99 - OTHER IMPROPER ACTION
5 - UNSAFE SPEED 11 - DROVE OFF ROAD
6 - IMPROPER TURN 12 - IMPROPER BACKING

TRAFFIC

TRAFFICWAY FLOW 2 1 - ONE-WAY 2 - TWO-WAY

TRAFFIC CONTROL 06 1 - ROUNDABOUT 4 - STOP SIGN 2 - SIGNAL 5 - YIELD SIGN 3 - FLASHER 6 - NO CONTROL

OF THROUGH LANES ON ROAD

RAIL GRADE CROSSING 1 - NOT INVOLVED 2 - INVOLVED-ACTIVE CROSSING 3 - INVOLVED-PASSIVE CROSSING

EVENT(S)

54 SEQUENCE OF EVENTS

1 1 - OVERTURN/ROLLOVER 6 - EQUIPMENT FAILURE 11 - CROSS CENTERLINE - OPPOSITE DIRECTION OF TRAVEL 16 - RAILWAY VEHICLE 22 - WORK ZONE MAINTENANCE EQUIPMENT
2 2 - FIRE/EXPLOSION 7 - SEPARATION OF UNITS 12 - DOWNHILL RUNAWAY 17 - ANIMAL - FARM 23 - STRUCK BY FALLING, SHIFTING CARGO OR ANYTHING SET IN MOTION BY A MOTOR VEHICLE
3 3 - IMMERSION 8 - RAN OFF ROAD RIGHT 13 - OTHER NON-COLLISION 18 - ANIMAL - DEER 24 - OTHER MOVABLE OBJECT
4 4 - JACKKNIFE 9 - RAN OFF ROAD LEFT 14 - PEDESTRIAN 19 - ANIMAL - OTHER 20 - MOTOR VEHICLE IN TRANSPORT
5 5 - CARGO / EQUIPMENT LOSS OR SHIFT 10 - CROSS MEDIAN 15 - PEDALCYCLE 21 - PARKED MOTOR VEHICLE
6 25 - IMPACT ATTENUATOR / CRASH CUSHION 31 - GUARDRAIL END 37 - TRAFFIC SIGN POST 43 - CURB 50 - WORK ZONE MAINTENANCE EQUIPMENT
26 - BRIDGE OVERHEAD STRUCTURE 32 - PORTABLE BARRIER 38 - OVERHEAD SIGN POST 44 - DITCH 51 - WALL
27 - BRIDGE PIER OR ABUTMENT 33 - MEDIAN CABLE BARRIER 39 - LIGHT / LUMINARIES SUPPORT 45 - EMBANKMENT 52 - BUILDING
28 - BRIDGE PARAPET 34 - MEDIAN GUARDRAIL BARRIER 40 - UTILITY POLE 46 - FENCE 53 - TUNNEL
29 - BRIDGE RAIL 35 - MEDIAN CONCRETE BARRIER 41 - OTHER POST, POLE OR SUPPORT 47 - MAILBOX 54 - OTHER FIXED OBJECT
30 - GUARDRAIL FACE 36 - MEDIAN OTHER BARRIER 42 - CULVERT 48 - TREE 99 - OTHER / UNKNOWN
49 - FIRE HYDRANT

COLLISION WITH FIXED OBJECT - STRUCK

1 FIRST HARMFUL EVENT 1 MOST HARMFUL EVENT

UNIT / NON-MOTORIST DIRECTION

FROM 2 TO 1

1 - NORTH 5 - NORTHEAST
2 - SOUTH 6 - NORTHWEST
3 - EAST 7 - SOUTHEAST
4 - WEST 8 - SOUTHWEST
9 - OTHER / UNKNOWN

UNIT SPEED 000

POSTED SPEED 00

DETECTED SPEED 3 1 - STATED / ESTIMATED SPEED
2 - CALCULATED / EDR
3 - UNDETERMINED

UNIT # 01	NAME: LAST, FIRST, MIDDLE DUGAN, AARON M		DATE OF BIRTH 03031991		AGE 28	GENDER M				
ADDRESS: STREET, CITY, STATE, ZIP 3031 HELEN PL NW CANTON OH 44708				CONTACT PHONE - INCLUDE AREA CODE						
INJURIES 5	INJURED TAKEN BY	EMS AGENCY (NAME)	INJURED TAKEN TO: MEDICAL FACILITY (NAME, CITY)	SAFETY EQUIPMENT USED 04	<input type="checkbox"/> DOT-COMPLIANT MC HELMET	SEATING POSITION 01	AIR BAG USAGE	EJECTION 1	TRAPPED 1	
OL STATE **	OPERATOR LICENSE NUMBER *****		OFFENSE CHARGED 4549.021	LOCAL CODE <input type="checkbox"/>	OFFENSE DESCRIPTION Accident Leaving Scene/Private		CITATION NUMBER 1169195			
OL CLASS 4	ENDORSEMENT SELECT UP TO 2	RESTRICTION SELECT UP TO 3	DRIVER DISTRACTED BY 9	ALCOHOL / DRUG SUSPECTED <input type="checkbox"/> ALCOHOL <input type="checkbox"/> MARIJUANA <input type="checkbox"/> OTHER DRUG		CONDITION 6	ALCOHOL TEST STATUS: 1, TYPE: 1, VALUE: .		DRUG TEST(S) STATUS: 1, TYPE: 1, RESULT: SELECT UP TO 4	

UNIT #	NAME: LAST, FIRST, MIDDLE		DATE OF BIRTH		AGE	GENDER				
ADDRESS: STREET, CITY, STATE, ZIP				CONTACT PHONE - INCLUDE AREA CODE						
INJURIES	INJURED TAKEN BY	EMS AGENCY (NAME)	INJURED TAKEN TO: MEDICAL FACILITY (NAME, CITY)	SAFETY EQUIPMENT USED	<input type="checkbox"/> DOT-COMPLIANT MC HELMET	SEATING POSITION	AIR BAG USAGE	EJECTION	TRAPPED	
OL STATE	OPERATOR LICENSE NUMBER		OFFENSE CHARGED	LOCAL CODE <input type="checkbox"/>	OFFENSE DESCRIPTION		CITATION NUMBER			
OL CLASS	ENDORSEMENT SELECT UP TO 2	RESTRICTION SELECT UP TO 3	DRIVER DISTRACTED BY	ALCOHOL / DRUG SUSPECTED <input type="checkbox"/> ALCOHOL <input type="checkbox"/> MARIJUANA <input type="checkbox"/> OTHER DRUG		CONDITION	ALCOHOL TEST STATUS, TYPE, VALUE		DRUG TEST(S) STATUS, TYPE, RESULT SELECT UP TO 4	

UNIT #	NAME: LAST, FIRST, MIDDLE		DATE OF BIRTH		AGE	GENDER				
ADDRESS: STREET, CITY, STATE, ZIP				CONTACT PHONE - INCLUDE AREA CODE						
INJURIES	INJURED TAKEN BY	EMS AGENCY (NAME)	INJURED TAKEN TO: MEDICAL FACILITY (NAME, CITY)	SAFETY EQUIPMENT USED	<input type="checkbox"/> DOT-COMPLIANT MC HELMET	SEATING POSITION	AIR BAG USAGE	EJECTION	TRAPPED	
OL STATE	OPERATOR LICENSE NUMBER		OFFENSE CHARGED	LOCAL CODE <input type="checkbox"/>	OFFENSE DESCRIPTION		CITATION NUMBER			
OL CLASS	ENDORSEMENT SELECT UP TO 2	RESTRICTION SELECT UP TO 3	DRIVER DISTRACTED BY	ALCOHOL / DRUG SUSPECTED <input type="checkbox"/> ALCOHOL <input type="checkbox"/> MARIJUANA <input type="checkbox"/> OTHER DRUG		CONDITION	ALCOHOL TEST STATUS, TYPE, VALUE		DRUG TEST(S) STATUS, TYPE, RESULT SELECT UP TO 4	

INJURIES	SEATING POSITION	AIR BAG	OL CLASS	OL RESTRICTION(S)	DRIVER DISTRACTION	TEST STATUS			
1 - FATAL 2 - SUSPECTED SERIOUS INJURY 3 - SUSPECTED MINOR INJURY 4 - POSSIBLE INJURY 5 - NO APPARENT INJURY	1 - FRONT - LEFT SIDE (MOTORCYCLE DRIVER) 2 - FRONT - MIDDLE 3 - FRONT - RIGHT SIDE 4 - SECOND - LEFT SIDE (MOTORCYCLE PASSENGER) 5 - SECOND - MIDDLE 6 - SECOND - RIGHT SIDE 7 - THIRD - LEFT SIDE (MOTORCYCLE SIDE CAR) 8 - THIRD - MIDDLE 9 - THIRD - RIGHT SIDE 10 - SLEEPER SECTION OF TRUCK CAB	1 - NOT DEPLOYED 2 - DEPLOYED FRONT 3 - DEPLOYED SIDE 4 - DEPLOYED BOTH FRONT / SIDE 5 - NOT APPLICABLE 9 - DEPLOYMENT UNKNOWN	1 - CLASS A 2 - CLASS B 3 - CLASS C 4 - REGULAR CLASS (OHIO = D) 5 - M/C MOPED ONLY 6 - NO VALID OL	1 - ALCOHOL INTERLOCK DEVICE 2 - CDL INTRASTATE ONLY 3 - CORRECTIVE LENSES 4 - FARM WAIVER 5 - EXCEPT CLASS A BUS 6 - EXCEPT CLASS A & CLASS B BUS 7 - EXCEPT TRACTOR-TRAILER 8 - INTERMEDIATE LICENSE RESTRICTIONS 9 - LEARNER'S PERMIT RESTRICTIONS 10 - LIMITED TO DAYLIGHT ONLY 11 - LIMITED TO EMPLOYMENT 12 - LIMITED - OTHER 13 - MECHANICAL DEVICES (SPECIAL BRAKES, HAND CONTROLS, OR OTHER ADAPTIVE DEVICES) 14 - MILITARY VEHICLES ONLY 15 - MOTOR VEHICLES WITHOUT AIR BRAKES 16 - OUTSIDE MIRROR 17 - PROSTHETIC AID 18 - OTHER	1 - NOT DISTRACTED 2 - MANUALLY OPERATING AN ELECTRONIC COMMUNICATION DEVICE (TEXTING, TYPING, DIALING) 3 - TALKING ON HANDS-FREE COMMUNICATION DEVICE 4 - TALKING ON HAND-HELD COMMUNICATION DEVICE 5 - OTHER ACTIVITY WITH AN ELECTRONIC DEVICE 6 - PASSENGER 7 - OTHER DISTRACTION INSIDE THE VEHICLE 8 - OTHER DISTRACTION OUTSIDE THE VEHICLE 9 - OTHER / UNKNOWN	1 - NONE GIVEN 2 - TEST REFUSED 3 - TEST GIVEN, CONTAMINATED SAMPLE / UNUSABLE 4 - TEST GIVEN, RESULTS KNOWN 5 - TEST GIVEN, RESULTS UNKNOWN			
INJURED TAKEN BY	1 - NOT TRANSPORTED /TREATED AT SCENE 2 - EMS 3 - POLICE 9 - OTHER / UNKNOWN	EJECTION	1 - NOT EJECTED 2 - PARTIALLY EJECTED 3 - TOTALLY EJECTED 4 - NOT APPLICABLE	OL ENDORSEMENT	H - HAZMAT M - MOTORCYCLE P - PASSENGER N - TANKER Q - MOTOR SCOOTER R - THREE-WHEEL MOTORCYCLE S - SCHOOL BUS T - DOUBLE & TRIPLE TRAILERS X - TANKER / HAZMAT	ALCOHOL TEST TYPE	1 - NONE 2 - BLOOD 3 - URINE 4 - BREATH 5 - OTHER		
SAFETY EQUIPMENT	1 - NONE USED 2 - SHOULDER BELT ONLY USED 3 - LAP BELT ONLY USED 4 - SHOULDER & LAP BELT USED 5 - CHILD RESTRAINT SYSTEM - FORWARD FACING 6 - CHILD RESTRAINT SYSTEM - REAR FACING 7 - BOOSTER SEAT 8 - HELMET USED 9 - PROTECTIVE PADS USED (ELBOW, KNEES, ETC.) 10 - REFLECTIVE CLOTHING 11 - LIGHTING - PEDESTRIAN / BICYCLE ONLY 99 - OTHER / UNKNOWN	TRAPPED	1 - NOT TRAPPED 2 - EXTRICATED BY MECHANICAL MEANS 3 - FREED BY NON-MECHANICAL MEANS	GENDER	F - FEMALE M - MALE U - OTHER / UNKNOWN	CONDITION	1 - APPARENTLY NORMAL 2 - PHYSICAL IMPAIRMENT 3 - EMOTIONAL (E.G., DEPRESSED, ANGRY, DISTURBED) 4 - ILLNESS 5 - FELL ASLEEP, FAINTED, FATIGUED, ETC. 6 - UNDER THE INFLUENCE OF MEDICATIONS / DRUGS / ALCOHOL 9 - OTHER / UNKNOWN	DRUG TEST TYPE	1 - NONE 2 - BLOOD 3 - URINE 4 - OTHER
						DRUG TEST RESULT(S)	1 - AMPHETAMINES 2 - BARBITURATES 3 - BENZODIAZEPINES 4 - CANNABINOIDS 5 - COCAINE 6 - OPIATES / OPIOIDS 7 - OTHER 8 - NEGATIVE RESULTS		