

# TRAFFIC CRASH REPORT

\*DENOTES MANDATORY FIELD FOR SUPPLEMENT REPORT

LOCAL REPORT NUMBER\*

23-44432

PHOTOS TAKEN  
 SECONDARY CRASH  
 OH-2  
 OH-3  
 OH-1P  
 OTHER  
 PRIVATE PROPERTY

LOCAL INFORMATION  
 REPORTING AGENCY NAME\*  
 JACKSON TWP POLICE DEPARTME

HIT/SKIP  
 1 - SOLVED  
 2 - UNSOLVED  
 NUMBER OF UNITS  
 01  
 UNIT IN ERROR  
 01 98 - ANIMAL  
 01 99 - UNKNOWN

COUNTY\* 76 LOCALITY\* 3  
 1 - CITY  
 2 - VILLAGE  
 3 - TOWNSHIP  
 LOCATION: CITY, VILLAGE, TOWNSHIP\*  
 Jackson (Township of)

CRASH DATE / TIME\*  
 08192023 1605  
 CRASH SEVERITY  
 5  
 1 - FATAL  
 2 - SERIOUS INJURY SUSPECTED  
 3 - MINOR INJURY SUSPECTED  
 4 - INJURY POSSIBLE  
 5 - PROPERTY DAMAGE ONLY

LOCATION  
 ROUTE TYPE ROUTE NUMBER PREFIX  
 1 - NORTH  
 2 - SOUTH  
 3 - EAST  
 4 - WEST  
 LOCATION ROAD NAME  
 FULTON  
 ROAD TYPE  
 DR

LATITUDE DECIMAL DEGREES  
 40.501834

REFERENCE  
 ROUTE TYPE ROUTE NUMBER PREFIX  
 1 - NORTH  
 2 - SOUTH  
 3 - EAST  
 4 - WEST  
 REFERENCE ROAD NAME (ROAD, MILEPOST, HOUSE #)  
 4024  
 ROAD TYPE

LONGITUDE DECIMAL DEGREES  
 -81.234703

REFERENCE POINT  
 3  
 1 - INTERSECTION  
 2 - MILE POST  
 3 - HOUSE #  
 DIRECTION FROM REFERENCE  
 1 - NORTH  
 2 - SOUTH  
 3 - EAST  
 4 - WEST  
 ROUTE TYPE  
 IR - INTERSTATE ROUTE (TP)  
 US - FEDERAL US ROUTE  
 SR - STATE ROUTE  
 CR - NUMBERED COUNTY ROUTE  
 TR - NUMBERED TOWNSHIP ROUTE  
 ROAD TYPE  
 AL - ALLEY HW - HIGHWAY RD - ROAD  
 AV - AVENUE LA - LANE SQ - SQUARE  
 BL - BOULEVARD MP - MILEPOST ST - STREET  
 CR - CIRCLE OV - OVAL TE - TERRACE  
 CT - COURT PK - PARKWAY TL - TRAIL  
 DR - DRIVE PI - PIKE WA - WAY  
 HE - HEIGHTS PL - PLACE

INTERSECTION RELATED  
 WITHIN INTERSECTION OR ON APPROACH  
 WITHIN INTERCHANGE AREA  
 NUMBER OF APPROACHES

LOCATION OF FIRST HARMFUL EVENT  
 06  
 1 - ON ROADWAY  
 2 - ON SHOULDER  
 3 - IN MEDIAN  
 4 - ON ROADSIDE  
 5 - ON GORE  
 6 - OUTSIDE TRAFFIC WAY  
 7 - ON RAMP  
 8 - OFF RAMP  
 9 - CROSSOVER  
 10 - DRIVEWAY/ALLEY ACCESS  
 11 - RAILWAY GRADE CROSSING  
 12 - SHARED USE PATHS OR TRAILS  
 13 - BIKE LANE  
 14 - TOLL BOOTH  
 99 - OTHER / UNKNOWN  
 MANNER OF CRASH COLLISION/IMPACT  
 1  
 1 - NOT COLLISION BETWEEN TWO MOTOR VEHICLES IN TRANSPORT  
 2 - REAR-END  
 3 - HEAD-ON  
 4 - REAR-TO-REAR  
 5 - BACKING  
 6 - ANGLE  
 7 - SIDESWIPE, SAME DIRECTION  
 8 - SIDESWIPE, OPPOSITE DIRECTION  
 9 - OTHER / UNKNOWN

DIRECTION OF TRAVEL  
 1 - NORTH  
 2 - SOUTH  
 3 - EAST  
 4 - WEST  
 MEDIAN TYPE  
 1 - DIVIDED FLUSH MEDIAN (<4 FEET)  
 2 - DIVIDED FLUSH MEDIAN (≥4 FEET)  
 3 - DIVIDED, DEPRESSED MEDIAN  
 4 - DIVIDED, RAISED MEDIAN (ANY TYPE)  
 9 - OTHER/UNKNOWN

WORK ZONE RELATED  
 WORKERS PRESENT  
 LAW ENFORCEMENT PRESENT  
 ACTIVE SCHOOL ZONE  
 WORK ZONE TYPE  
 1 - LANE CLOSURE  
 2 - LANE SHIFT/CROSSOVER  
 3 - WORK ON SHOULDER OR MEDIAN  
 4 - INTERMITTENT OR MOVING WORK  
 5 - OTHER  
 LOCATION OF CRASH IN WORK ZONE  
 1 - BEFORE THE 1ST WORK ZONE WARNING SIGN  
 2 - ADVANCE WARNING AREA  
 3 - TRANSITION AREA  
 4 - ACTIVITY AREA  
 5 - TERMINATION AREA

CONTOUR  
 1  
 1 - STRAIGHT LEVEL  
 2 - STRAIGHT GRADE  
 3 - CURVE LEVEL  
 4 - CURVE GRADE  
 9 - OTHER/UNKNOWN  
 CONDITIONS  
 1  
 1 - DRY  
 2 - WET  
 3 - SNOW  
 4 - ICE  
 5 - SAND, MUD, DIRT, OIL, GRAVEL  
 6 - WATER (STANDING, MOVING)  
 7 - SLUSH  
 9 - OTHER/UNKNOWN  
 SURFACE  
 2  
 1 - CONCRETE  
 2 - BLACKTOP, BITUMINOUS, ASPHALT  
 3 - BRICK/BLOCK  
 4 - SLAG, GRAVEL, STONE  
 5 - DIRT  
 9 - OTHER/UNKNOWN

LIGHT CONDITION  
 1  
 1 - DAYLIGHT  
 2 - DAWN/DUSK  
 3 - DARK - LIGHTED ROADWAY  
 4 - DARK - ROADWAY NOT LIGHTED  
 5 - DARK - UNKNOWN ROADWAY LIGHTING  
 9 - OTHER / UNKNOWN  
 WEATHER  
 1  
 1 - CLEAR  
 2 - CLOUDY  
 3 - FOG, SMOG, SMOKE  
 4 - RAIN  
 5 - SLEET, HAIL  
 6 - SNOW  
 7 - SEVERE CROSSWINDS  
 8 - BLOWING SAND, SOIL, DIRT, SNOW  
 9 - FREEZING RAIN OR FREEZING DRIZZLE  
 99 - OTHER / UNKNOWN

NARRATIVE  
 UNIT 1 WAS BACKING INTO A MARKED PARKING SPACE AND STRUCK A PILLAR CONNECTED TO THE BUILDING. NO INJURIES REPORTED.  
 GM

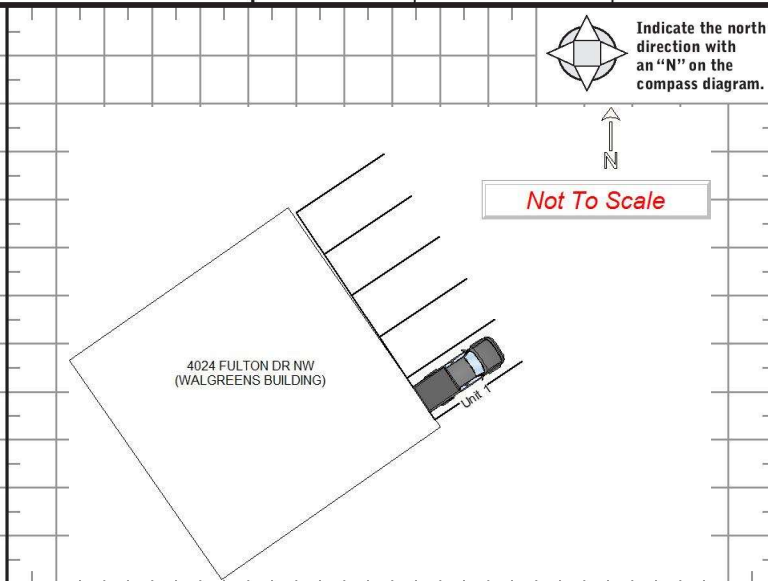

CRASH REPORTED DATE / TIME: 08192023 1605  
 DISPATCH DATE / TIME: 08192023 1608  
 ARRIVAL DATE / TIME: 08192023 1611  
 SCENE CLEARED DATE / TIME: 08192023 1649  
 REPORT TAKEN BY  
 POLICE AGENCY  
 MOTORIST  
 SUPPLEMENT (CORRECTION OR ADDITION TO AN EXISTING REPORT SENT TO OOPS)  
 TOTAL TIME ROADWAY CLOSED: 0  
 OTHER INVESTIGATION TIME: 0  
 TOTAL MINUTES: 41  
 OFFICER'S NAME\*: RISHER, RYAN  
 OFFICER'S BADGE NUMBER\*: 1 2 1  
 CHECKED BY OFFICER'S NAME\*: JOHNSON, STEVEN  
 CHECKED BY OFFICER'S BADGE NUMBER\*: 2 2

23-44432

**OWNER**

UNIT # 01 OWNER NAME: LAST, FIRST, MIDDLE (  SAME AS DRIVER ) **BUILDER BROS CONSTRUCTION** OWNER PHONE: INCLUDE AREA CODE (  SAME AS DRIVER )

OWNER ADDRESS: STREET, CITY, STATE, ZIP (  SAME AS DRIVER )  
**223 N BROADWAY ST NEW PHILADELPHIA OH 44663**

COMMERCIAL CARRIER: NAME, ADDRESS, CITY, STATE, ZIP COMMERCIAL CARRIER PHONE: INCLUDE AREA CODE

**DAMAGE**

**DAMAGE SCALE**

2 1 - NONE 3 - FUNCTIONAL DAMAGE  
 2 - MINOR DAMAGE 4 - DISABLING DAMAGE  
 9 - UNKNOWN

**VEHICLE**

LP STATE OH LICENSE PLATE # PLM9902 VEHICLE IDENTIFICATION # 1GCGTAE39F1242383 VEHICLE YEAR 2015 VEHICLE MAKE CHEV

INSURANCE VERIFIED INSURANCE COMPANY GEICO INSURANCE POLICY # 9300029752 COLOR RED VEHICLE MODEL COLO

COMMERCIAL  GOVERNMENT  IN EMERGENCY RESPONSE TYPE OF USE US DOT # TOWED BY: COMPANY NAME

INTERLOCK DEVICE EQUIPPED  HIT/SKIP UNIT #OCCUPANTS 02 VEHICLE WEIGHT GVWR/GCWR 1 - ≤10K LBS. 2 - 10,001 - 26K LBS. 3 - >26K LBS.  MATERIAL RELEASED  PLACARD CLASS # PLACARD ID #

04 1 - PASSENGER CAR 7 - MOTORCYCLE 2-WHEELED 12 - GOLF CART 18 - LIMO (LIVERY VEHICLE) 23 - PEDESTRIAN / SKATER  
 2 - PASSENGER VAN (MINIVAN) 8 - MOTORCYCLE 3-WHEELED 13 - SNOWMOBILE 19 - BUS (16+ PASSENGERS) 24 - WHEELCHAIR (ANY TYPE)  
 3 - SPORT UTILITY VEHICLE 9 - AUTOCYCLE 14 - SINGLE UNIT TRUCK 20 - OTHER VEHICLE 25 - OTHER NON-MOTORIST  
 4 - PICK UP 10 - MOPED OR MOTORIZED BICYCLE 15 - SEMI-TRACTOR 21 - HEAVY EQUIPMENT 26 - BICYCLE  
 5 - CARGO VAN 11 - ALL TERRAIN VEHICLE (ATV / UTV) 16 - FARM EQUIPMENT 22 - ANIMAL WITH RIDER OR ANIMAL-DRAWN VEHICLE 27 - TRAIN  
 6 - VAN (9-15 SEATS) 17 - MOTORHOME 99 - UNKNOWN OR HIT/SKIP

0 # OF TRAILING UNITS

2 WAS VEHICLE OPERATING IN AUTONOMOUS MODE WHEN CRASH OCCURRED? 0 0 - NO AUTOMATION 3 - CONDITIONAL AUTOMATION 9 - UNKNOWN  
 1 - YES 2 - NO 9 - OTHER / UNKNOWN 1 - DRIVER ASSISTANCE 4 - HIGH AUTOMATION 5 - FULL AUTOMATION 2 - PARTIAL AUTOMATION

01 1 - NONE 6 - BUS - CHARTER/TOUR 11 - FIRE 16 - FARM 21 - MAIL CARRIER  
 2 - TAXI 7 - BUS - INTERCITY 12 - MILITARY 17 - MOWING 99 - OTHER / UNKNOWN  
 3 - ELECTRONIC RIDE SHARING 8 - BUS - SHUTTLE 13 - POLICE 18 - SNOW REMOVAL  
 4 - SCHOOL TRANSPORT 9 - BUS - OTHER 14 - PUBLIC UTILITY 19 - TOWING  
 5 - BUS - TRANSIT/COMMUTER 10 - AMBULANCE 15 - CONSTRUCTION EQUIPMENT 20 - SAFETY SERVICE PATROL

01 1 - NO CARGO BODY TYPE / NOT APPLICABLE 3 - VEHICLE TOWING ANOTHER MOTOR VEHICLE 5 - INTERMODAL CONTAINER CHASSIS 8 - POLE 12 - CONCRETE MIXER  
 2 - BUS 4 - LOGGING 6 - CARGO VAN/ENCLOSED BOX 10 - FLAT BED 13 - AUTO TRANSPORTER  
 14 - GARBAGE/REFUSE 99 - OTHER / UNKNOWN

1 - TURN SIGNALS 4 - BRAKES 7 - WORN OR SLICK TIRES 9 - MOTOR TROUBLE 99 - OTHER / UNKNOWN  
 2 - HEAD LAMPS 5 - STEERING 8 - TRAILER EQUIPMENT DEFECTIVE 10 - DISABLED FROM PRIOR ACCIDENT  
 3 - TAIL LAMPS 6 - TIRE BLOWOUT

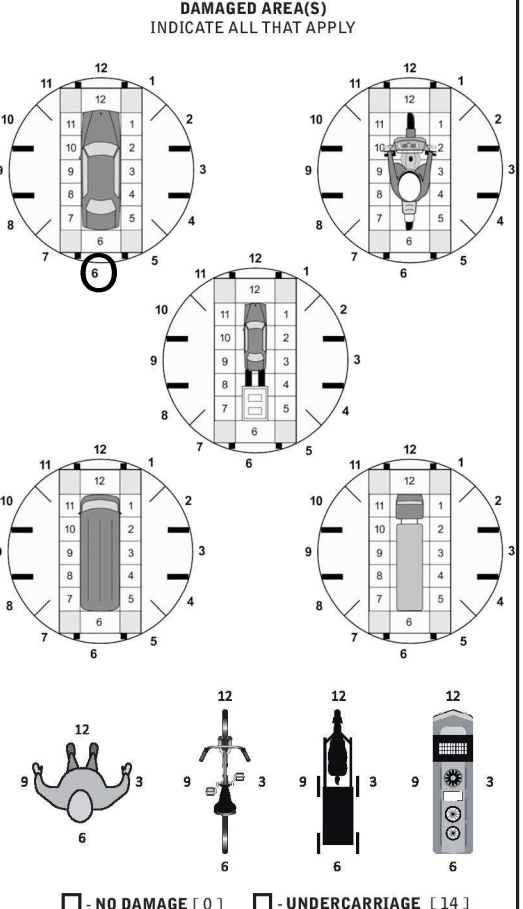

1 - INTERSECTION - MARKED CROSSWALK 3 - INTERSECTION - OTHER 6 - BICYCLE LANE 9 - MEDIAN/CROSSING ISLAND 12 - FIRST RESPONDER AT INCIDENT SCENE  
 2 - INTERSECTION - UNMARKED CROSSWALK 4 - MIDBLOCK - MARKED CROSSWALK 7 - SHOULDER / ROADSIDE 10 - DRIVEWAY ACCESS 13 - AUTO TRANSPORTER  
 5 - TRAVEL LANE - OTHER LOCATION 8 - SIDEWALK 11 - SHARED USE PATHS OR TRAILS 99 - OTHER / UNKNOWN

3 1 - NON-CONTACT 2 - NON-COLLISION 3 - STRIKING 4 - STRUCK 5 - BOTH STRIKING & STRUCK 9 - OTHER / UNKNOWN 02 1 - STRAIGHT AHEAD 2 - BACKING 3 - CHANGING LANES 4 - OVERTAKING/PASSING 5 - MAKING RIGHT TURN 6 - MAKING LEFT TURN 7 - MAKING U-TURN 8 - ENTERING TRAFFIC LANE 9 - LEAVING TRAFFIC LANE 10 - PARKED 11 - SLOWING OR STOPPED IN TRAFFIC 12 - DRIVERLESS 13 - NEGOTIATING A CURVE 14 - ENTERING OR CROSSING SPECIFIED LOCATION 15 - WALKING, RUNNING, JOGGING, PLAYING 16 - WORKING 17 - PUSHING VEHICLE 18 - APPROACHING OR LEAVING VEHICLE 19 - STANDING 20 - OTHER NON-MOTORIST 21 - STANDING OUTSIDE DISABLED VEHICLE 99 - OTHER / UNKNOWN

**INITIAL POINT OF CONTACT**

6 0 - NO DAMAGE 14 - UNDERCARRIAGE  
 1-12 - REFER TO UNIT DIAGRAM 15 - VEHICLE NOT AT SCENE  
 99 - UNKNOWN 13 - TOP

12 1 - NONE 2 - FAILURE TO YIELD 3 - RAN RED LIGHT 4 - RAN STOP SIGN 5 - UNSAFE SPEED 6 - IMPROPER TURN 7 - LEFT OF CENTER 8 - FOLLOWING TOO CLOSE / ACDA 9 - IMPROPER LANE CHANGE 10 - IMPROPER PASSING 11 - DROVE OFF ROAD 12 - IMPROPER BACKING 13 - IMPROPER START FROM A PARKED POSITION 14 - STOPPED OR PARKED ILLEGALLY 15 - SWERVING TO AVOID 16 - WRONG WAY 17 - VISION OBSTRUCTION 18 - OPERATING DEFECTIVE EQUIPMENT 19 - LOAD SHIFTING/FALLING/SPILLING 20 - IMPROPER CROSSING 21 - LYING IN ROADWAY 22 - NOT DISCERNIBLE 23 - OPENING DOOR INTO ROADWAY 99 - OTHER IMPROPER ACTION

**TRAFFIC**

**TRAFFICWAY FLOW** 2 1 - ONE-WAY 2 - TWO-WAY

**TRAFFIC CONTROL** 06 1 - ROUNDABOUT 4 - STOP SIGN 2 - SIGNAL 5 - YIELD SIGN 3 - FLASHER 6 - NO CONTROL

**# OF THROUGH LANES ON ROAD** 2

**RAIL GRADE CROSSING** 1 1 - NOT INVOLVED 2 - INVOLVED-ACTIVE CROSSING 3 - INVOLVED-PASSIVE CROSSING

**EVENT(S)**

52 1 - OVERTURN/ROLLOVER 2 - FIRE/EXPLOSION 3 - IMMERSION 4 - JACKKNIFE 5 - CARGO / EQUIPMENT LOSS OR SHIFT 6 - EQUIPMENT FAILURE 7 - SEPARATION OF UNITS 8 - RAN OFF ROAD RIGHT 9 - RAN OFF ROAD LEFT 10 - CROSS MEDIAN 11 - CROSS CENTERLINE - OPPOSITE DIRECTION OF TRAVEL 12 - DOWNHILL RUNAWAY 13 - OTHER NON-COLLISION 14 - PEDESTRIAN 15 - PEDALCYCLE 16 - RAILWAY VEHICLE 17 - ANIMAL - FARM 18 - ANIMAL - DEER 19 - ANIMAL - OTHER 20 - MOTOR VEHICLE IN TRANSPORT 21 - PARKED MOTOR VEHICLE 22 - WORK ZONE MAINTENANCE EQUIPMENT 23 - STRUCK BY FALLING, SHIFTING CARGO OR ANYTHING SET IN MOTION BY A MOTOR VEHICLE 24 - OTHER MOVABLE OBJECT

**SEQUENCE OF EVENTS**

4 25 - IMPACT ATTENUATOR / CRASH CUSHION 26 - BRIDGE OVERHEAD STRUCTURE 27 - BRIDGE PIER OR ABUTMENT 28 - BRIDGE PARAPET 29 - BRIDGE RAIL 30 - GUARDRAIL FACE 31 - GUARDRAIL END 32 - PORTABLE BARRIER 33 - MEDIAN CABLE BARRIER 34 - MEDIAN GUARDRAIL BARRIER 35 - MEDIAN CONCRETE BARRIER 36 - MEDIAN OTHER BARRIER 37 - TRAFFIC SIGN POST 38 - OVERHEAD SIGN POST 39 - LIGHT / LUMINARIES SUPPORT 40 - UTILITY POLE 41 - OTHER POST, POLE OR SUPPORT 42 - CULVERT 43 - CURB 44 - DITCH 45 - EMBANKMENT 46 - FENCE 47 - MAILBOX 48 - TREE 49 - FIRE HYDRANT 50 - WORK ZONE MAINTENANCE EQUIPMENT 51 - WALL 52 - BUILDING 53 - TUNNEL 54 - OTHER FIXED OBJECT 99 - OTHER / UNKNOWN

**COLLISION WITH FIXED OBJECT - STRUCK**

1 **FIRST HARMFUL EVENT** 1 **MOST HARMFUL EVENT**

**UNIT / NON-MOTORIST DIRECTION**

FROM 1 TO 2

1 - NORTH 5 - NORTHEAST  
 2 - SOUTH 6 - NORTHWEST  
 3 - EAST 7 - SOUTHEAST  
 4 - WEST 8 - SOUTHWEST  
 9 - OTHER / UNKNOWN

**UNIT SPEED** 002

**POSTED SPEED** 25

**DETECTED SPEED** 1 1 - STATED / ESTIMATED SPEED 2 - CALCULATED / EDR 3 - UNDETERMINED

<b>UNIT #</b> 01	<b>NAME: LAST, FIRST, MIDDLE</b> WOOD, AUSTIN J	<b>DATE OF BIRTH</b> 01281995	<b>AGE</b> 28	<b>GENDER</b> M
<b>ADDRESS: STREET, CITY, STATE, ZIP</b> 2918 ARBORETUM CIR NW CANTON OH 44708		<b>CONTACT PHONE - INCLUDE AREA CODE</b> 		
<b>INJURIES</b> 5	<b>INJURED TAKEN BY</b> 	<b>EMS AGENCY (NAME)</b> 	<b>INJURED TAKEN TO: MEDICAL FACILITY (NAME, CITY)</b> 	<b>SAFETY EQUIPMENT USED</b> 04
<input type="checkbox"/> DOT-Compliant MC HELMET	<b>SEATING POSITION</b> 01	<b>AIR BAG USAGE</b> 1	<b>EJECTION</b> 1	<b>TRAPPED</b> 1
<b>OL STATE</b> **	<b>OPERATOR LICENSE NUMBER</b> *****	<b>OFFENSE CHARGED</b> 	<b>LOCAL CODE</b> <input type="checkbox"/>	<b>OFFENSE DESCRIPTION</b> 
<b>OL CLASS</b> 4	<b>ENDORSEMENT</b> 	<b>RESTRICTION</b> SELECT UP TO 3 	<b>DRIVER DISTRACTED BY</b> 1	<b>ALCOHOL / DRUG SUSPECTED</b> <input type="checkbox"/> ALCOHOL <input type="checkbox"/> MARIJUANA <input type="checkbox"/> OTHER DRUG
<b>CONDITION</b> 1		<b>ALCOHOL TEST</b>		<b>DRUG TEST(S)</b>
		<b>STATUS</b> 1	<b>TYPE</b> 1	<b>VALUE</b> 
		<b>STATUS</b> 1	<b>TYPE</b> 1	<b>RESULT</b> SELECT UP TO 4 

<b>UNIT #</b>	<b>NAME: LAST, FIRST, MIDDLE</b>	<b>DATE OF BIRTH</b>	<b>AGE</b>	<b>GENDER</b>
<b>ADDRESS: STREET, CITY, STATE, ZIP</b>		<b>CONTACT PHONE - INCLUDE AREA CODE</b>		
<b>INJURIES</b>	<b>INJURED TAKEN BY</b>	<b>EMS AGENCY (NAME)</b>	<b>INJURED TAKEN TO: MEDICAL FACILITY (NAME, CITY)</b>	<b>SAFETY EQUIPMENT USED</b>
<input type="checkbox"/> DOT-Compliant MC HELMET	<b>SEATING POSITION</b>	<b>AIR BAG USAGE</b>	<b>EJECTION</b>	<b>TRAPPED</b>
<b>OL STATE</b>	<b>OPERATOR LICENSE NUMBER</b>	<b>OFFENSE CHARGED</b>	<b>LOCAL CODE</b>	<b>OFFENSE DESCRIPTION</b>
<b>OL CLASS</b>	<b>ENDORSEMENT</b>	<b>RESTRICTION</b> SELECT UP TO 3	<b>DRIVER DISTRACTED BY</b>	<b>ALCOHOL / DRUG SUSPECTED</b>
<b>CONDITION</b>		<b>ALCOHOL TEST</b>		<b>DRUG TEST(S)</b>
		<b>STATUS</b>	<b>TYPE</b>	<b>VALUE</b>
		<b>STATUS</b>	<b>TYPE</b>	<b>RESULT</b> SELECT UP TO 4

<b>UNIT #</b>	<b>NAME: LAST, FIRST, MIDDLE</b>	<b>DATE OF BIRTH</b>	<b>AGE</b>	<b>GENDER</b>
<b>ADDRESS: STREET, CITY, STATE, ZIP</b>		<b>CONTACT PHONE - INCLUDE AREA CODE</b>		
<b>INJURIES</b>	<b>INJURED TAKEN BY</b>	<b>EMS AGENCY (NAME)</b>	<b>INJURED TAKEN TO: MEDICAL FACILITY (NAME, CITY)</b>	<b>SAFETY EQUIPMENT USED</b>
<input type="checkbox"/> DOT-Compliant MC HELMET	<b>SEATING POSITION</b>	<b>AIR BAG USAGE</b>	<b>EJECTION</b>	<b>TRAPPED</b>
<b>OL STATE</b>	<b>OPERATOR LICENSE NUMBER</b>	<b>OFFENSE CHARGED</b>	<b>LOCAL CODE</b>	<b>OFFENSE DESCRIPTION</b>
<b>OL CLASS</b>	<b>ENDORSEMENT</b>	<b>RESTRICTION</b> SELECT UP TO 3	<b>DRIVER DISTRACTED BY</b>	<b>ALCOHOL / DRUG SUSPECTED</b>
<b>CONDITION</b>		<b>ALCOHOL TEST</b>		<b>DRUG TEST(S)</b>
		<b>STATUS</b>	<b>TYPE</b>	<b>VALUE</b>
		<b>STATUS</b>	<b>TYPE</b>	<b>RESULT</b> SELECT UP TO 4

INJURIES	SEATING POSITION	AIR BAG	OL CLASS	OL RESTRICTION(S)	DRIVER DISTRACTION	TEST STATUS
1 - FATAL 2 - SUSPECTED SERIOUS INJURY 3 - SUSPECTED MINOR INJURY 4 - POSSIBLE INJURY 5 - NO APPARENT INJURY	1 - FRONT - LEFT SIDE (MOTORCYCLE DRIVER) 2 - FRONT - MIDDLE 3 - FRONT - RIGHT SIDE 4 - SECOND - LEFT SIDE (MOTORCYCLE PASSENGER) 5 - SECOND - MIDDLE 6 - SECOND - RIGHT SIDE 7 - THIRD - LEFT SIDE (MOTORCYCLE SIDE CAR) 8 - THIRD - MIDDLE 9 - THIRD - RIGHT SIDE 10 - SLEEPER SECTION OF TRUCK CAB 11 - PASSENGER IN OTHER ENCLOSED CARGO AREA (NON-TRAILING UNIT, BUS, PICK-UP WITH CAP) 12 - PASSENGER IN UNENCLOSED CARGO AREA 13 - TRAILING UNIT 14 - RIDING ON VEHICLE EXTERIOR (NON-TRAILING UNIT) 15 - NON-MOTORIST 99 - OTHER / UNKNOWN	1 - NOT DEPLOYED 2 - DEPLOYED FRONT 3 - DEPLOYED SIDE 4 - DEPLOYED BOTH FRONT / SIDE 5 - NOT APPLICABLE 9 - DEPLOYMENT UNKNOWN	1 - CLASS A 2 - CLASS B 3 - CLASS C 4 - REGULAR CLASS (OHIO = D) 5 - M/C MOPED ONLY 6 - NO VALID OL	1 - ALCOHOL INTERLOCK DEVICE 2 - CDL INTRASTATE ONLY 3 - CORRECTIVE LENSES 4 - FARM WAIVER 5 - EXCEPT CLASS A BUS 6 - EXCEPT CLASS A & CLASS B BUS 7 - EXCEPT TRACTOR-TRAILER 8 - INTERMEDIATE LICENSE RESTRICTIONS 9 - LEARNER'S PERMIT RESTRICTIONS 10 - LIMITED TO DAYLIGHT ONLY 11 - LIMITED TO EMPLOYMENT 12 - LIMITED - OTHER 13 - MECHANICAL DEVICES (SPECIAL BRAKES, HAND CONTROLS, OR OTHER ADAPTIVE DEVICES) 14 - MILITARY VEHICLES ONLY 15 - MOTOR VEHICLES WITHOUT AIR BRAKES 16 - OUTSIDE MIRROR 17 - PROSTHETIC AID 18 - OTHER	1 - NOT DISTRACTED 2 - MANUALLY OPERATING AN ELECTRONIC COMMUNICATION DEVICE (TEXTING, TYPING, DIALING) 3 - TALKING ON HANDS-FREE COMMUNICATION DEVICE 4 - TALKING ON HAND-HELD COMMUNICATION DEVICE 5 - OTHER ACTIVITY WITH AN ELECTRONIC DEVICE 6 - PASSENGER 7 - OTHER DISTRACTION INSIDE THE VEHICLE 8 - OTHER DISTRACTION OUTSIDE THE VEHICLE 9 - OTHER / UNKNOWN	1 - NONE GIVEN 2 - TEST REFUSED 3 - TEST GIVEN, CONTAMINATED SAMPLE / UNUSABLE 4 - TEST GIVEN, RESULTS KNOWN 5 - TEST GIVEN, RESULTS UNKNOWN
<b>INJURED TAKEN BY</b>		<b>EJECTION</b>	<b>OL ENDORSEMENT</b>			<b>ALCOHOL TEST TYPE</b>
1 - NOT TRANSPORTED /TREATED AT SCENE 2 - EMS 3 - POLICE 9 - OTHER / UNKNOWN		1 - NOT EJECTED 2 - PARTIALLY EJECTED 3 - TOTALLY EJECTED 4 - NOT APPLICABLE	H - HAZMAT M - MOTORCYCLE P - PASSENGER N - TANKER Q - MOTOR SCOOTER R - THREE-WHEEL MOTORCYCLE S - SCHOOL BUS T - DOUBLE & TRIPLE TRAILERS X - TANKER / HAZMAT			1 - NONE 2 - BLOOD 3 - URINE 4 - BREATH 5 - OTHER
<b>SAFETY EQUIPMENT</b>		<b>TRAPPED</b>	<b>GENDER</b>		<b>CONDITION</b>	<b>DRUG TEST TYPE</b>
1 - NONE USED 2 - SHOULDER BELT ONLY USED 3 - LAP BELT ONLY USED 4 - SHOULDER & LAP BELT USED 5 - CHILD RESTRAINT SYSTEM - FORWARD FACING 6 - CHILD RESTRAINT SYSTEM - REAR FACING 7 - BOOSTER SEAT 8 - HELMET USED 9 - PROTECTIVE PADS USED (ELBOW, KNEES, ETC.) 10 - REFLECTIVE CLOTHING 11 - LIGHTING - PEDESTRIAN / BICYCLE ONLY 99 - OTHER / UNKNOWN		1 - NOT TRAPPED 2 - EXTRICATED BY MECHANICAL MEANS 3 - FREED BY NON-MECHANICAL MEANS	F - FEMALE M - MALE U - OTHER / UNKNOWN		1 - APPARENTLY NORMAL 2 - PHYSICAL IMPAIRMENT 3 - EMOTIONAL (E.G., DEPRESSED, ANGRY, DISTURBED) 4 - ILLNESS 5 - FELL ASLEEP, FAINTED, FATIGUED, ETC. 6 - UNDER THE INFLUENCE OF MEDICATIONS / DRUGS /ALCOHOL 9 - OTHER / UNKNOWN	1 - NONE 2 - BLOOD 3 - URINE 4 - OTHER
						<b>DRUG TEST RESULT(S)</b>
						1 - AMPHETAMINES 2 - BARBITURATES 3 - BENZODIAZEPINES 4 - CANNABINOIDS 5 - COCAINE 6 - OPIATES / OPIOIDS 7 - OTHER 8 - NEGATIVE RESULTS

# OCCUPANT / WITNESS ADDENDUM

LOCAL REPORT NUMBER  
23-44432

<b>OCCUPANT</b>	<b>UNIT #</b> 01	<b>NAME:</b> LAST, FIRST, MIDDLE WOOD, COURTNEY R	<b>DATE OF BIRTH</b> 12311997	<b>AGE</b> 25	<b>GENDER</b> F				
	<b>ADDRESS:</b> STREET, CITY, STATE, ZIP 2918 ARBORETUM CIR NW CANTON OH 44708			<b>CONTACT PHONE - INCLUDE AREA CODE</b>					
<b>INJURIES</b> 5	<b>INJURED TAKEN BY</b>	<b>EMS AGENCY (NAME)</b>	<b>INJURED TAKEN TO: MEDICAL FACILITY (NAME, CITY)</b>	<b>SAFETY EQUIPMENT USED</b> 04	<input type="checkbox"/> <b>DOT-COMPLIANT MC HELMET</b>	<b>SEATING POSITION</b> 03	<b>AIR BAG USAGE</b> 1	<b>EJECTION</b> 1	<b>TRAPPED</b> 1

<b>OCCUPANT</b>	<b>UNIT #</b>	<b>NAME:</b> LAST, FIRST, MIDDLE	<b>DATE OF BIRTH</b>	<b>AGE</b>	<b>GENDER</b>				
	<b>ADDRESS:</b> STREET, CITY, STATE, ZIP			<b>CONTACT PHONE - INCLUDE AREA CODE</b>					
<b>INJURIES</b>	<b>INJURED TAKEN BY</b>	<b>EMS AGENCY (NAME)</b>	<b>INJURED TAKEN TO: MEDICAL FACILITY (NAME, CITY)</b>	<b>SAFETY EQUIPMENT USED</b>	<input type="checkbox"/> <b>DOT-COMPLIANT MC HELMET</b>	<b>SEATING POSITION</b>	<b>AIR BAG USAGE</b>	<b>EJECTION</b>	<b>TRAPPED</b>

<b>OCCUPANT</b>	<b>UNIT #</b>	<b>NAME:</b> LAST, FIRST, MIDDLE	<b>DATE OF BIRTH</b>	<b>AGE</b>	<b>GENDER</b>				
	<b>ADDRESS:</b> STREET, CITY, STATE, ZIP			<b>CONTACT PHONE - INCLUDE AREA CODE</b>					
<b>INJURIES</b>	<b>INJURED TAKEN BY</b>	<b>EMS AGENCY (NAME)</b>	<b>INJURED TAKEN TO: MEDICAL FACILITY (NAME, CITY)</b>	<b>SAFETY EQUIPMENT USED</b>	<input type="checkbox"/> <b>DOT-COMPLIANT MC HELMET</b>	<b>SEATING POSITION</b>	<b>AIR BAG USAGE</b>	<b>EJECTION</b>	<b>TRAPPED</b>

<b>OCCUPANT</b>	<b>UNIT #</b>	<b>NAME:</b> LAST, FIRST, MIDDLE	<b>DATE OF BIRTH</b>	<b>AGE</b>	<b>GENDER</b>				
	<b>ADDRESS:</b> STREET, CITY, STATE, ZIP			<b>CONTACT PHONE - INCLUDE AREA CODE</b>					
<b>INJURIES</b>	<b>INJURED TAKEN BY</b>	<b>EMS AGENCY (NAME)</b>	<b>INJURED TAKEN TO: MEDICAL FACILITY (NAME, CITY)</b>	<b>SAFETY EQUIPMENT USED</b>	<input type="checkbox"/> <b>DOT-COMPLIANT MC HELMET</b>	<b>SEATING POSITION</b>	<b>AIR BAG USAGE</b>	<b>EJECTION</b>	<b>TRAPPED</b>

INJURIES	SAFETY EQUIPMENT USED	SEATING POSITION	AIR BAG USAGE
1 - FATAL	1 - NONE USED - VEHICLE OCCUPANT	1 - FRONT - LEFT SIDE (MOTORCYCLE DRIVER)	1 - NOT DEPLOYED
2 - SUSPECTED SERIOUS INJURY	2 - SHOULDER BELT ONLY USED	2 - FRONT - MIDDLE	2 - DEPLOYED FRONT
3 - SUSPECTED MINOR INJURY	3 - LAP BELT ONLY USED	3 - FRONT - RIGHT SIDE	3 - DEPLOYED SIDE
4 - POSSIBLE INJURY	4 - SHOULDER & LAP BELT USED	4 - SECOND - LEFT SIDE (MOTORCYCLE PASSENGER)	4 - DEPLOYED BOTH FRONT/SIDE
5 - NO APPARENT INJURY	5 - CHILD RESTRAINT SYSTEM - FORWARD FACING	5 - SECOND - MIDDLE	5 - NOT APPLICABLE
<b>INJURED TAKEN BY</b>	6 - CHILD RESTRAINT SYSTEM - REAR FACING	6 - SECOND - RIGHT SIDE	9 - DEPLOYMENT UNKNOWN
1 - NOT TRANSPORTED / TREATED AT SCENE	7 - BOOSTER SEAT	7 - THIRD - LEFT SIDE (MOTORCYCLE SIDE CAR)	<b>EJECTION</b>
2 - EMS	8 - HELMET USED	8 - THIRD - MIDDLE	1 - NOT EJECTED
3 - POLICE	9 - PROTECTIVE PADS USED (ELBOW, KNEES, ETC.)	9 - THIRD - RIGHT SIDE	2 - PARTIALLY EJECTED
9 - OTHER / UNKNOWN	10 - REFLECTIVE CLOTHING	10 - SLEEPER SECTION OF TRUCK CAB	3 - TOTALLY EJECTED
<b>GENDER</b>	11 - LIGHTING - PEDESTRIAN / BICYCLE ONLY	11 - PASSENGER IN OTHER ENCLOSED CARGO AREA (NON-TRAILING UNIT, BUS, PICK-UP WITH CAP)	4 - NOT APPLICABLE
F - FEMALE	99 - OTHER / UNKNOWN	12 - PASSENGER IN UNENCLOSED CARGO AREA	<b>TRAPPED</b>
M - MALE		13 - TRAILING UNIT	1 - NOT TRAPPED
U - OTHER / UNKNOWN		14 - RIDING ON VEHICLE EXTERIOR (NON-TRAILING UNIT)	2 - EXTRICATED BY MECHANICAL MEANS
		15 - NON-MOTORIST	3 - FREED BY NON-MECHANICAL MEANS
		99 - OTHER / UNKNOWN	

<b>WITNESS</b>	<b>NAME:</b> LAST, FIRST, MIDDLE	<b>DATE OF BIRTH</b>	<b>AGE</b>	<b>GENDER</b>
	<b>ADDRESS:</b> STREET, CITY, STATE, ZIP			<b>CONTACT PHONE - INCLUDE AREA CODE</b>

<b>WITNESS</b>	<b>NAME:</b> LAST, FIRST, MIDDLE	<b>DATE OF BIRTH</b>	<b>AGE</b>	<b>GENDER</b>
	<b>ADDRESS:</b> STREET, CITY, STATE, ZIP			<b>CONTACT PHONE - INCLUDE AREA CODE</b>

<b>WITNESS</b>	<b>NAME:</b> LAST, FIRST, MIDDLE	<b>DATE OF BIRTH</b>	<b>AGE</b>	<b>GENDER</b>
	<b>ADDRESS:</b> STREET, CITY, STATE, ZIP			<b>CONTACT PHONE - INCLUDE AREA CODE</b>